

G ELECTRICAL WIRING ROUTING

Position of Parts in Engine Compartment

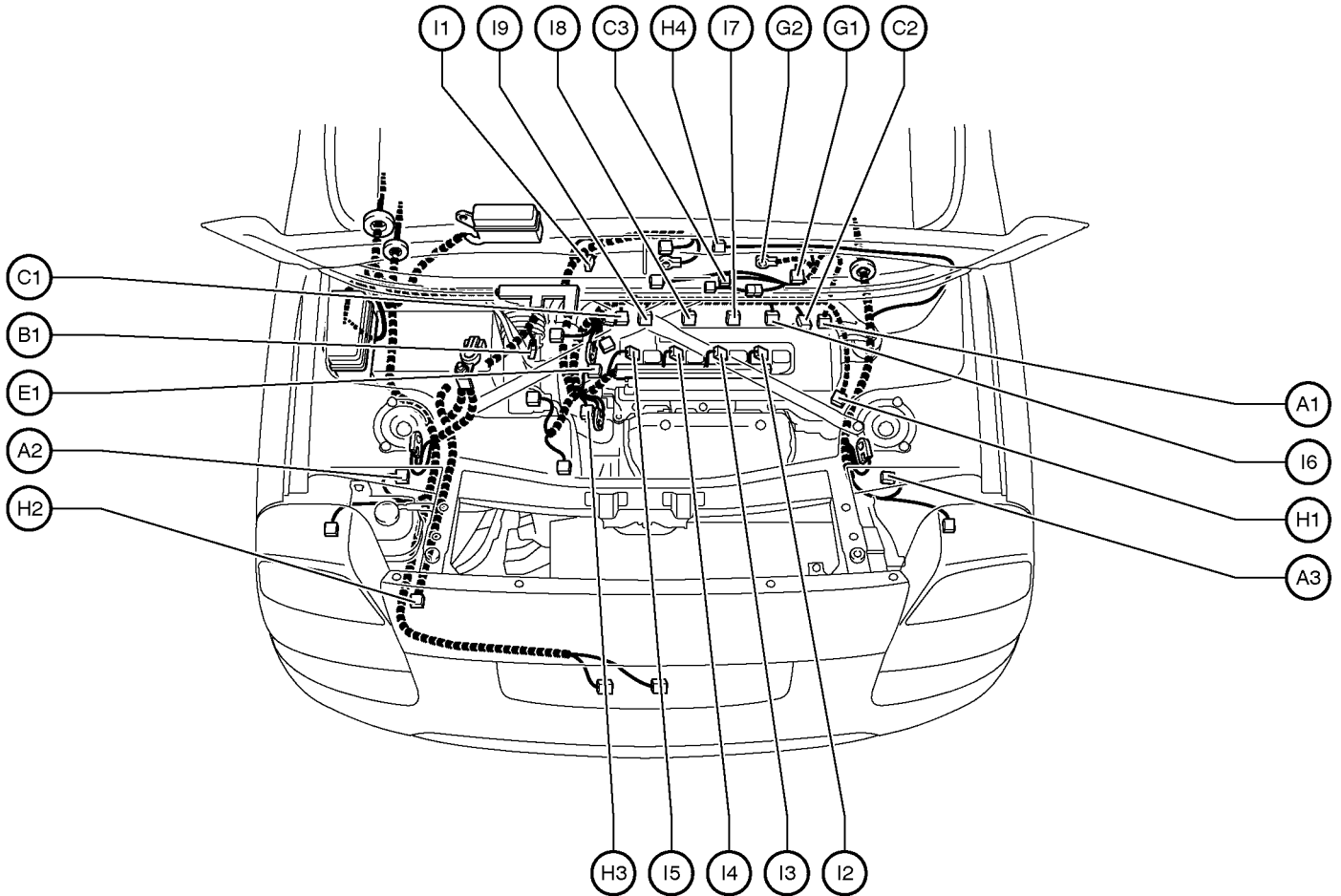

- A 1 A/C Magnetic Clutch and Lock Sensor
- A 2 ABS Speed Sensor Rear LH
- A 3 ABS Speed Sensor Rear RH

- B 1 Back-Up Light SW

- C 1 Camshaft Position Sensor
- C 2 Camshaft Timing Oil Control Valve
- C 3 Crankshaft Position Sensor

- E 1 Engine Coolant Temp. Sensor

- G 1 Generator
- G 2 Generator

- H 1 Heated Oxygen Sensor (Bank 1 Sensor 1)
- H 2 Heated Oxygen Sensor (Bank 1 Sensor 2)
- H 3 Heated Oxygen Sensor (Bank 2 Sensor 1)
- H 4 High Mounted Stop Light

- I 1 Idle Air Control Valve
- I 2 Ignition Coil and Igniter No.1
- I 3 Ignition Coil and Igniter No.2
- I 4 Ignition Coil and Igniter No.3
- I 5 Ignition Coil and Igniter No.4
- I 6 Injector No.1
- I 7 Injector No.2
- I 8 Injector No.3
- I 9 Injector No.4

Position of Parts in Engine Compartment

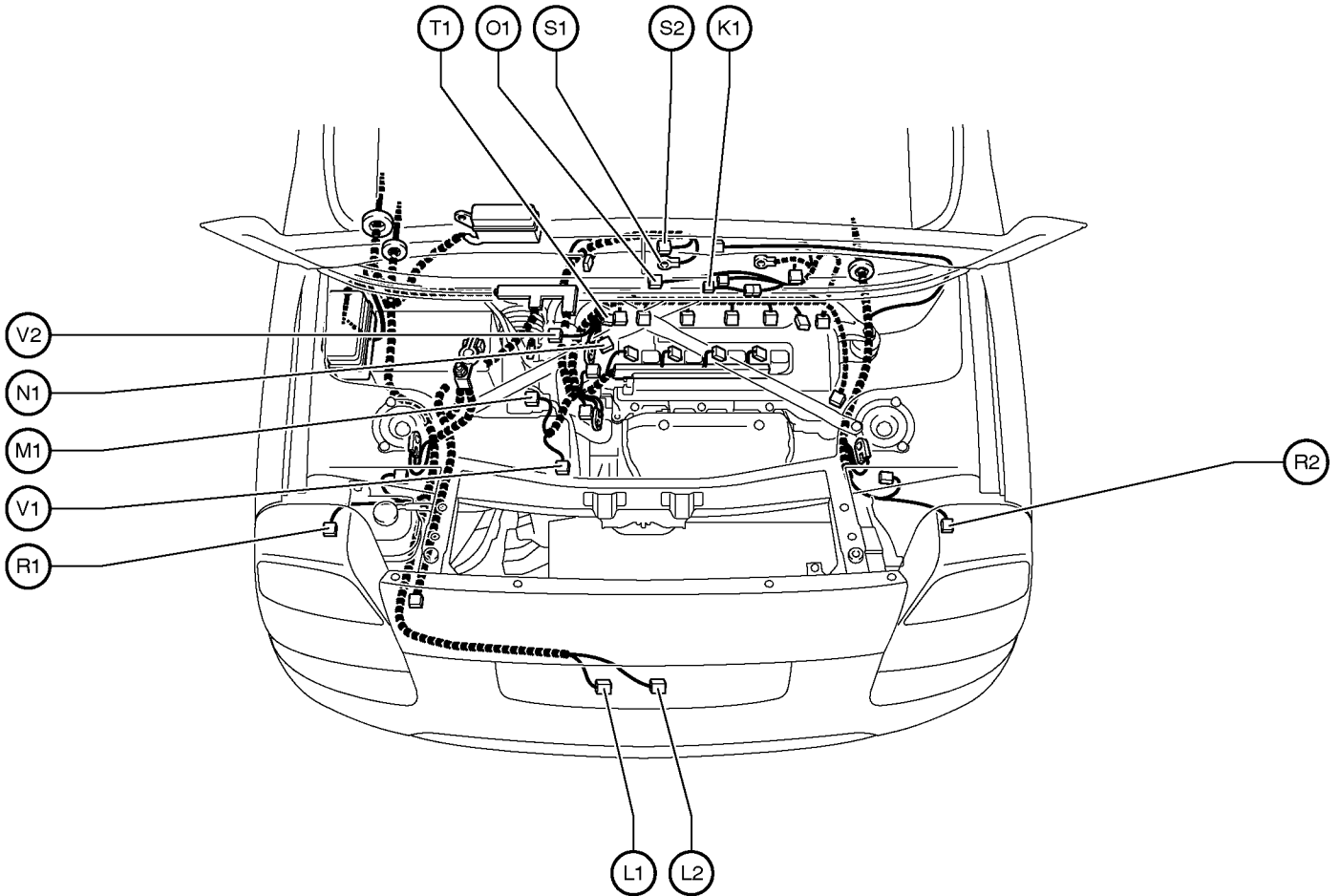

K 1 Knock Sensor

L 1 License Plate Light LH
L 2 License Plate Light RH

M 1 Mass Air Flow Meter

N 1 Noise Filter (Ignition)

O 1 Oil Pressure SW

R 1 Rear Combination Light LH
R 2 Rear Combination Light RH

S 1 Starter
S 2 Starter

T 1 Throttle Position Sensor

V 1 VSV (Canister Closed Valve)
V 2 VSV (EVAP)

G ELECTRICAL WIRING ROUTING

Position of Parts in Instrument Panel

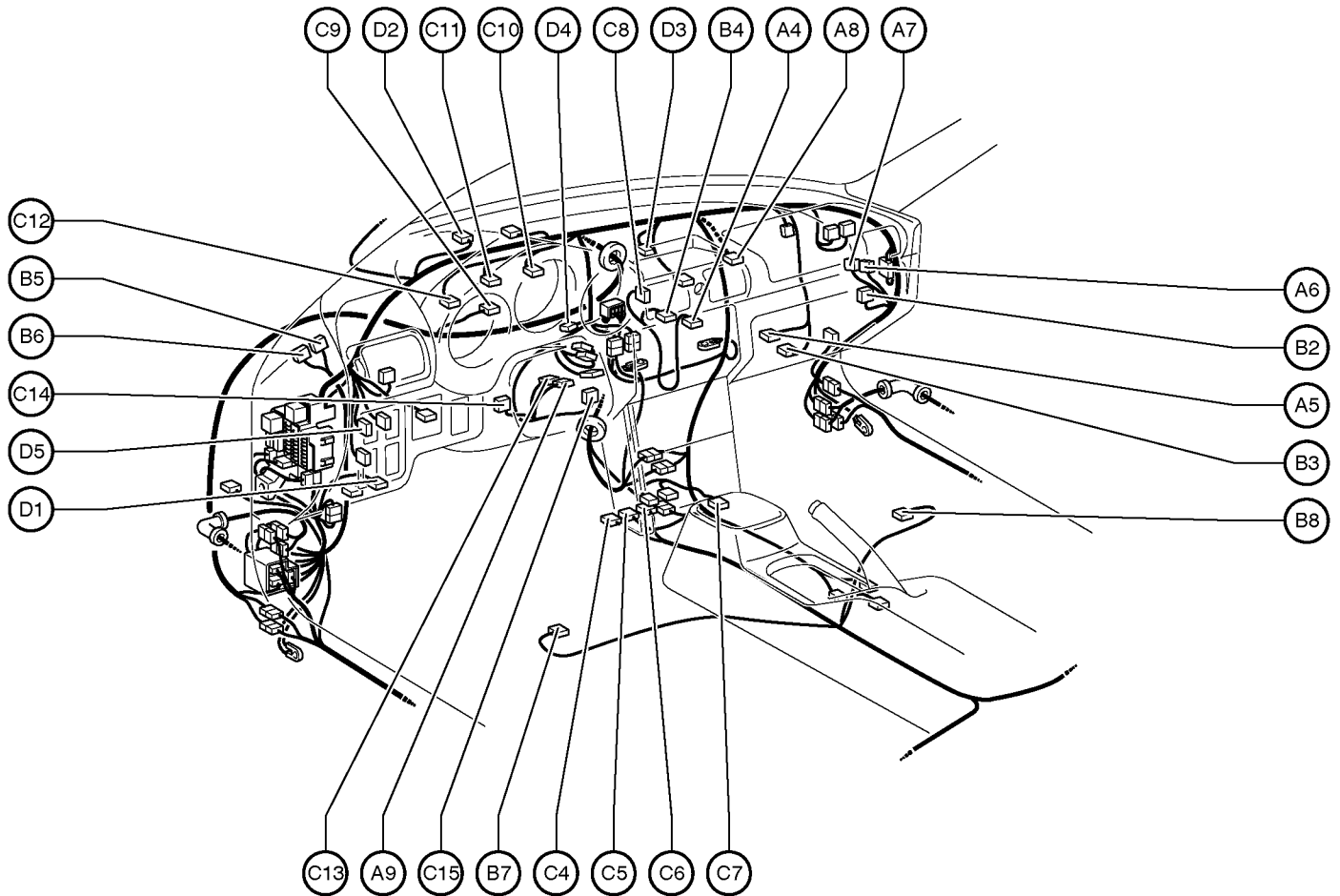

- A 4 A/C SW
- A 5 A/C Thermistor
- A 6 ABS ECU
- A 7 ABS ECU
- A 8 Airbag Squib (Passenger's Airbag Assembly)
- A 9 Airbag Squib (Steering Wheel Pad)

- B 2 Blower Motor
- B 3 Blower Resistor
- B 4 Blower SW
- B 5 Body ECU
- B 6 Body ECU
- B 7 Buckle SW and Tension Reducer LH
- B 8 Buckle SW RH and Seat Belt Warning Occupant Detection Sensor

- C 4 Center Airbag Sensor Assembly
- C 5 Center Airbag Sensor Assembly
- C 6 Center Airbag Sensor Assembly
- C 7 Cigarette Light
- C 8 Clock
- C 9 Clutch Start SW
- C10 Combination Meter
- C11 Combination Meter
- C12 Combination Meter
- C13 Combination SW
- C14 Combination SW
- C15 Combination SW

- D 1 Data Link Connector 3
- D 2 Daytime Running Light Relay
- D 3 Diode (Door Courtesy)
- D 4 Diode (DRL)
- D 5 Door Lock Control SW

Position of Parts in Instrument Panel

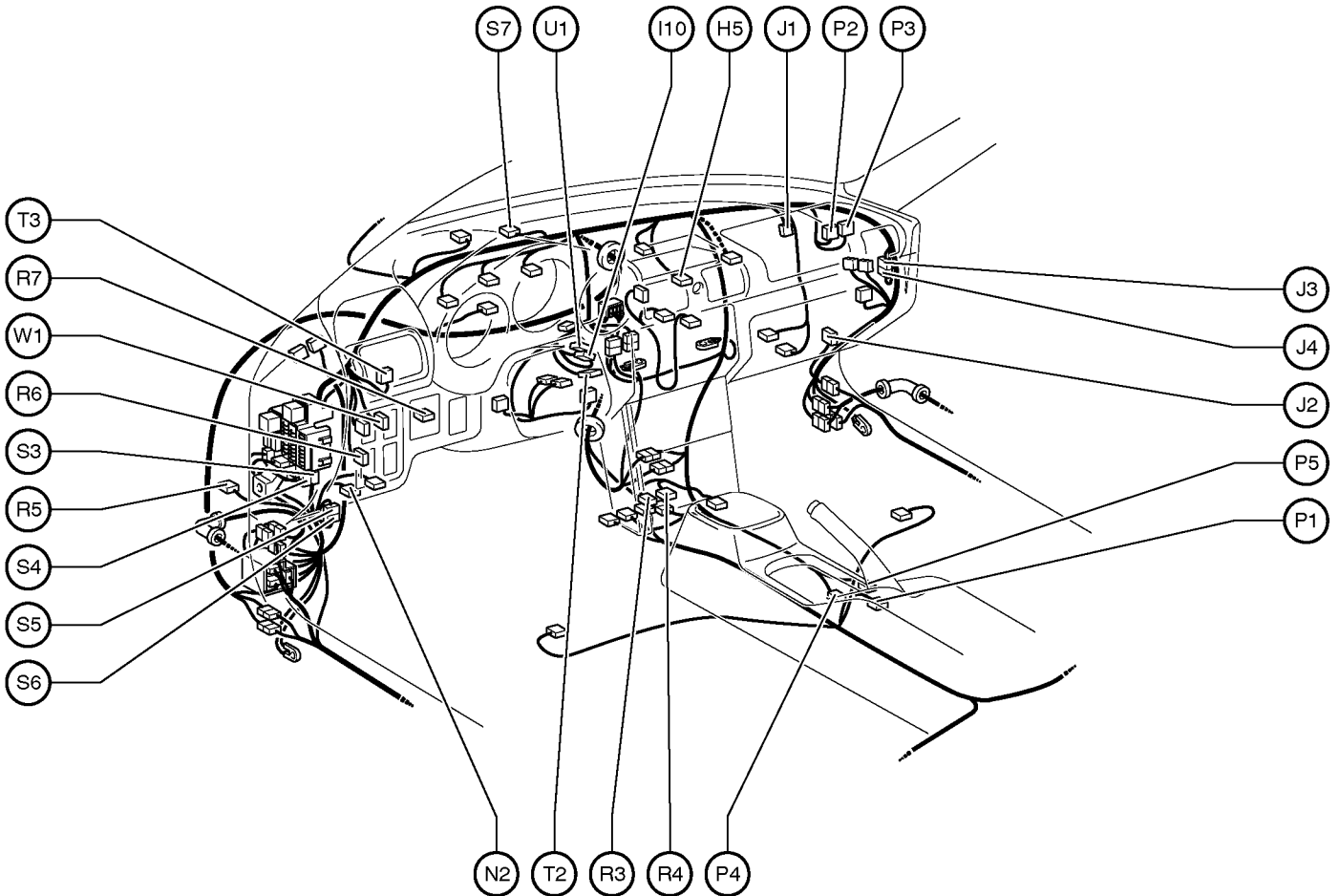

H 5 Hazard SW

I 10 Ignition SW

J 1 Junction Connector

J 2 Junction Connector

J 3 Junction Connector

J 4 Junction Connector

N 2 Noise Filter (Rear Window Defogger)

P 1 Parking Brake SW

P 2 Passenger Airbag Manual ON/OFF SW

P 3 Passenger Airbag Manual ON/OFF SW

P 4 Power Window Control SW LH

P 5 Power Window Control SW RH

R 3 Radio and Player

R 4 Radio and Player

R 5 Rear Window Defogger Relay

R 6 Rheostat

R 7 Remote Control Mirror SW

S 3 Short Connector (SRS No.1)

S 4 Short Connector (SRS No.1)

S 5 Short Connector (SRS No.2)

S 6 Short Connector (SRS No.2)

S 7 Stop Light SW

T 2 Transponder Key Amplifier

T 3 Turn Signal Flasher Relay

U 1 Unlock Warning SW

W 1 Window Lock SW

G ELECTRICAL WIRING ROUTING

Position of Parts in Body

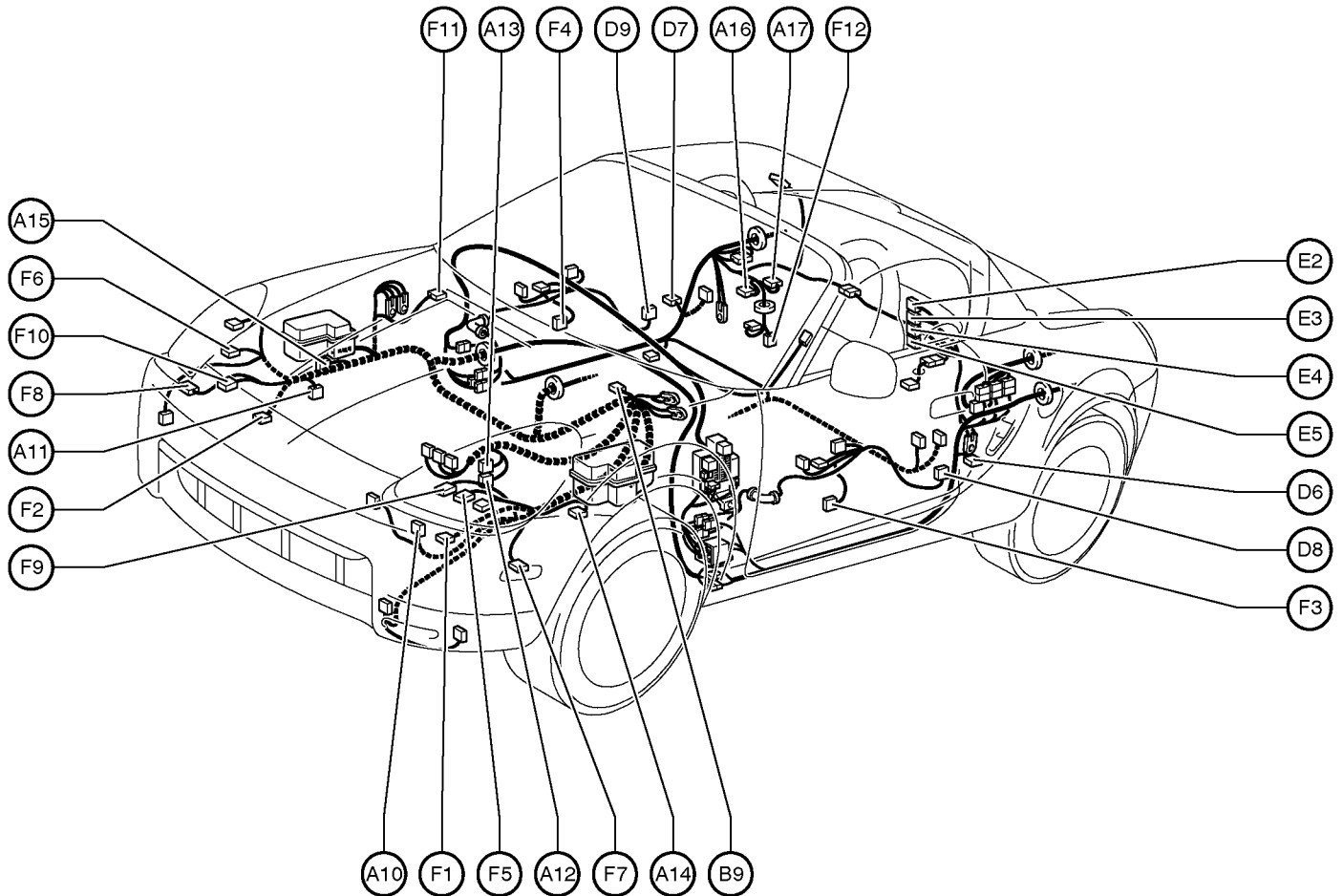

- | | |
|---|---------------------------------|
| A 10 A/C Condenser Fan Motor | E 2 Engine Control Module |
| A 11 A/C Triple Pressure SW
(A/C Dual and Single Pressure SW) | E 3 Engine Control Module |
| A 12 ABS Actuator | E 4 Engine Control Module |
| A 13 ABS Actuator | E 5 Engine Control Module |
| A 14 ABS Speed Sensor Front LH | F 1 Front Airbag Sensor LH |
| A 15 ABS Speed Sensor Front RH | F 2 Front Airbag Sensor RH |
| A 16 Auto Antenna Motor | F 3 Front Door Speaker LH |
| A 17 Auto Antenna Relay | F 4 Front Door Speaker RH |
| B 9 Brake Fluid Level Warning SW | F 5 Front Parking Light LH |
| D 6 Door Courtesy SW LH | F 6 Front Parking Light RH |
| D 7 Door Courtesy SW RH | F 7 Front Side Marker Light LH |
| D 8 Door Lock Motor, Door Key Lock and Unlock SW and
Door Unlock Detection SW LH | F 8 Front Side Marker Light RH |
| D 9 Door Lock Motor, Door Key Lock and Unlock SW and
Door Unlock Detection SW RH | F 9 Front Turn Signal Light LH |
| | F 10 Front Turn Signal Light RH |
| | F 11 Front Wiper Motor |
| | F 12 Fuel Pump and Fuel Sender |

Position of Parts in Body

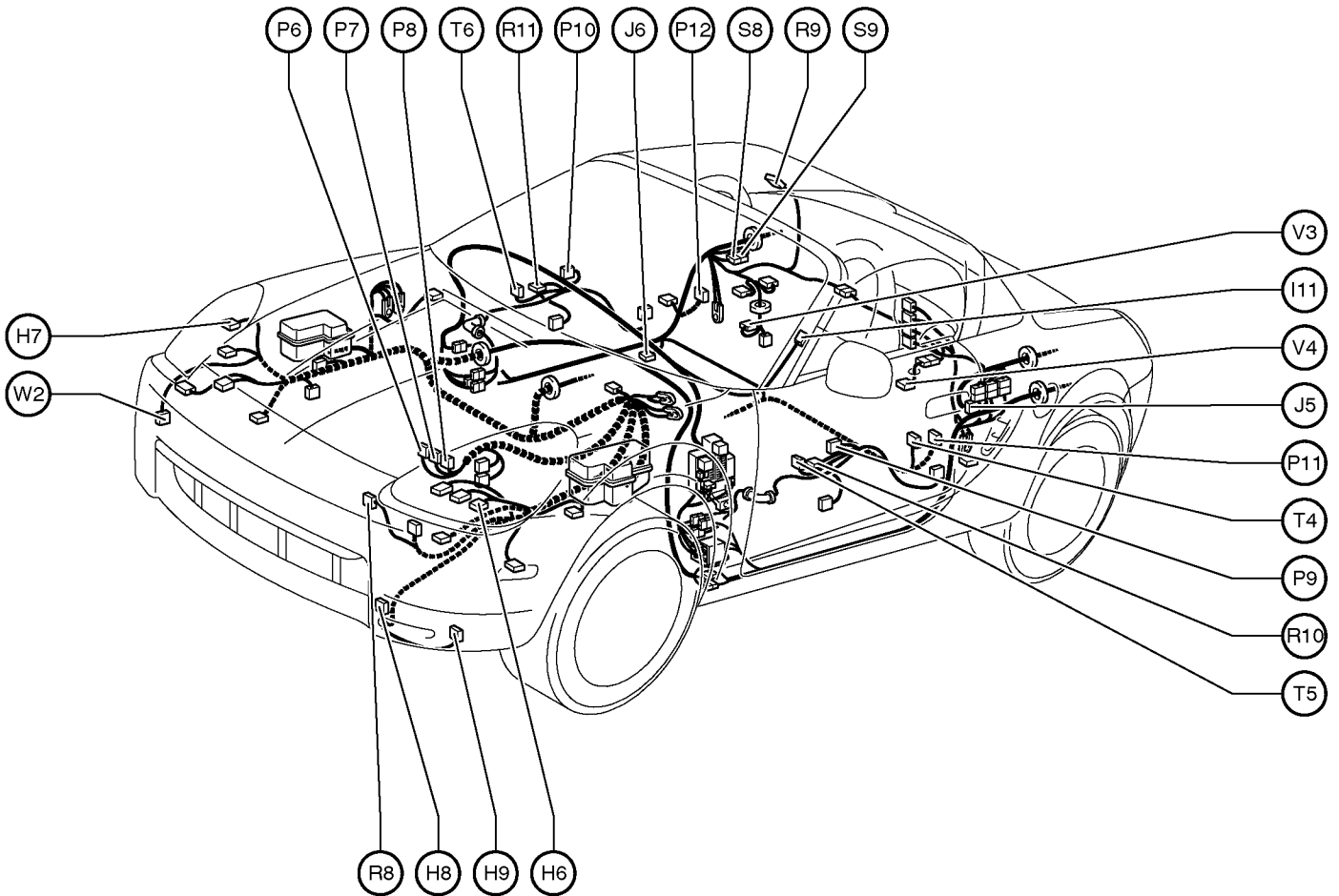

H 6 Headlight LH
 H 7 Headlight RH
 H 8 Horn LH
 H 9 Horn RH

I 11 Interior Light

J 5 Junction Connector
 J 6 Junction Connector

P 6 Power Steering ECU
 P 7 Power Steering ECU
 P 8 Power Steering ECU
 P 9 Power Window Motor LH
 P10 Power Window Motor RH
 P11 Pretensioner LH
 P12 Pretensioner RH

R 8 Radiator Fan Motor
 R 9 Rear Window Defogger
 R10 Remote Control Mirror LH
 R11 Remote Control Mirror RH

S 8 Short Connector (Rear Window Defogger)
 S 9 Short Connector (Rear Window Defogger)

T 4 Tension Reducer Solenoid LH
 T 5 Tweeter LH
 T 6 Tweeter RH

V 3 Vapor Pressure Sensor
 V 4 VSV(Pressure Switching Valve)

W 2 Washer Motor